

# Gigabit Ethernet Adapter (GBA-L) Installation

**NEC**  
INT-2060 (INST)

## Summary

The GBA-L UNIT (Gigabit Ethernet Adapter) is a switching HUB that connects to the NEC IP terminals, and provides the function of the Gigabit Ethernet for the LAN interface.

## Parts List

- |   |   |
|---|---|
| 1. Main Body                                      | 1 |
| 2. Lan Cable for Terminal Connection (about 40cm) | 1 |
| 3. DC cable (about 30cm)                          | 1 |
| 4. Connection Manual (this sheet)                 | 1 |
| 5. Support Panel                                  | 1 |
| 6. Leg Stand                                      | 1 |

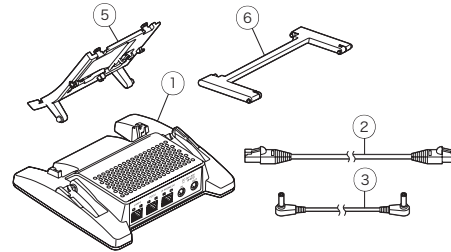

## Preparation

### General Information

CAT5e or higher LAN Cable (CAT 6 recommended)  
(Length of LAN cable from the LAN to the GBA-L UNIT is dependant on the customer needs.)

### AC Adapter

When the HUB for IEEE802.3af Power over Ethernet (PoE) is not used, the AC adapter (AC-L UNIT) is needed.  
(Sold Separately.)  
When options (8LK,16LK) are added to the terminal, the optional adapter can receive power from the PoE.

## Specifications

Item		Contents
Interface	LAN	1000Base-T (IEEE802.3ab) / 100Base-TX (IEEE802.3u) / 10Base-T (IEEE802.3i) Auto Negotiation RJ45 connection
	PC	1000Base-T (IEEE802.3ab) / 100Base-TX (IEEE802.3u) / 10Base-T (IEEE802.3i) Auto Negotiation RJ45 connection
	IP Terminal	100Base-TX (IEEE802.3u) / 10Base-T (IEEE802.3i) Auto Negotiation RJ45 connection
Power Supply		PoE IEEE802.3af or DC 27V (AC-L UNIT)

## Installation Procedure

- 1 Turn the terminal over.
- 2 Move tilt legs toward to the first position. (Figure 1)
- 3 Push stoppers a and b through grooves A and B, then expand the legs. (Figure 1)

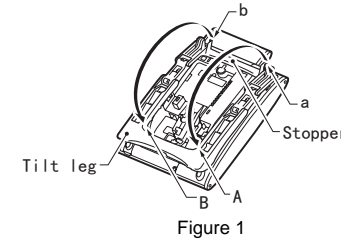

- 4 Remove the legs by pressing the tabs and sliding the legs down. (Figure 2)

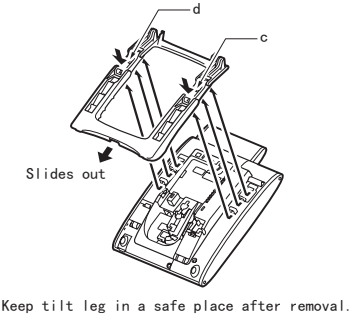

- 5 After connecting the LAN cable, place it into the groove. (Figure 3)

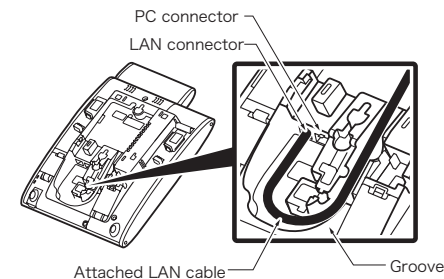

- 6 Attach the DC cable as shown in Figure 4.

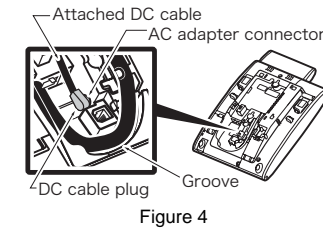

- 7 When connecting the support panel, feed the cables through the square hole.

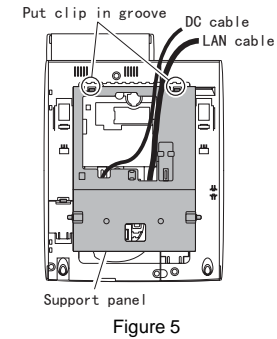

- 8 Install the support panel by sliding it in the direction of the arrows. (Figure 6)

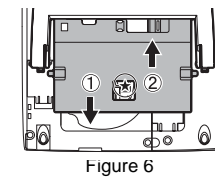

- 9 Place the cables into the guide groove.

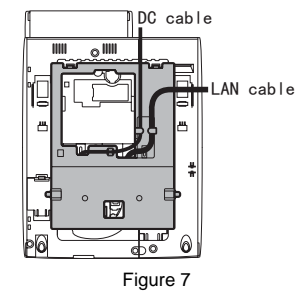

10 Line up the markings on the crossbar and the support panel and assemble. Connect the assembled piece onto the Gigabit Adapter.

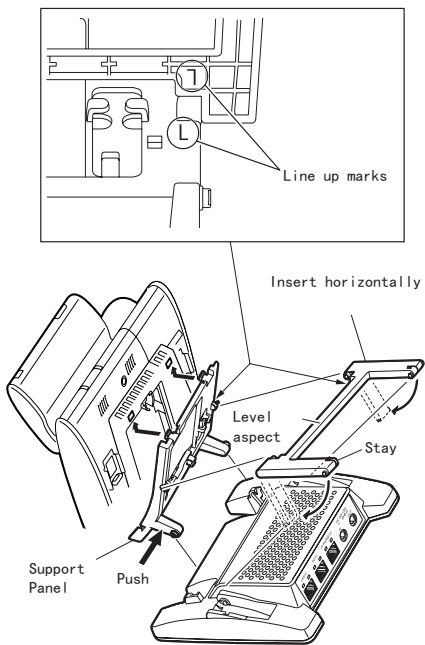

Figure 8

11 Connect the IP cable from the terminal into the jack named “IP PHONE (X)”.

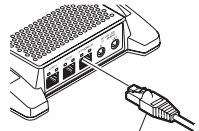

Figure 9

Note Do not connect anything other than the IP Terminal into the IP PHONE connector. If other equipment is connected, it may cause equipment damage.

12 If connecting to a PC, insert the cable from the PC into the jack labeled “PC(X)”.

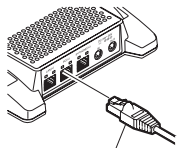

Figure 10

Note Do not connect anything other than a PC into the PC(X) connector. If other equipment is connected, it may cause equipment damage.

13 Connect the DC cable into the jack labeled “DC OUT” on the GBA-L UNIT.

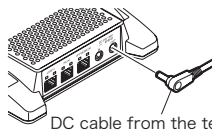

Figure 11

14 Insert the LAN cable into the jack labeled “LAN(=)”. If PoE is connected, it starts here.

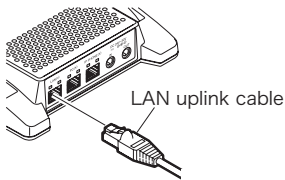

Figure 12

15 Plug the AC adapter into the jack labeled “DC IN” on the GBA-L UNIT. Verify all connections. (Figure 13)

Note Please plug the AC adapter into DC IN.

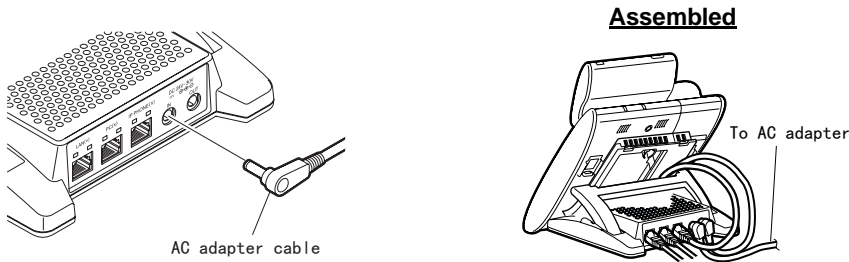
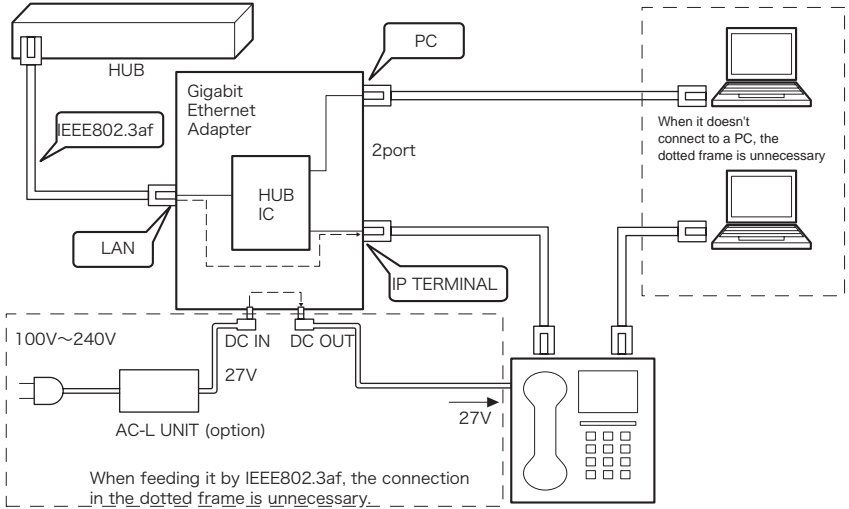
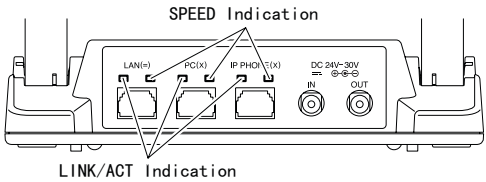

Figure 13

• Connection Outline



• LED Indicators



• Speed Display

LED Name	1000Mbps Connected	100Mbps Connect	10Mbps Connect
SPEED Indication	Green Light	Red Light	Off

LINK/ACT Display

LED Name	LINK Time	ACT At time of communication
LINK/ACT Indication	Green Light	Blinking Green