



Product information

Application

Mounting Flange Industrial IP67

Ethernet protocols are increasingly transferred to harsh industrial environments exposed to pollution. With this in mind, Dätwyler is offering the MS Industrial IP67 System based on the tried and tested MS Module systems. The future-proof system for the connection of 8 wires consists of Cat 6 RJ45 Industrial connector boxes as well as Cat 6 RJ45 Industrial connectors, which satisfy the requirements for a Class E (250 MHz) transmission distance in accordance with ISO/IEC 11801:2002 and EN 50173-1:2002.

The components are utilized in the area of structured cabling within the harsh industrial sector (protection class IP67) in accordance with EN 50173-2 (Draft) (Environment classes M_3 I_3 C_3 E_3). In order to ensure a secure data transmission, the modular inserts aligned to each other offer a wide surface screen contact of 360° which has excellent EMV properties.

The cover, permanently attached to the casing of the mounting flange, serves to close the opening of the jack when unmated, and prevents dust, dirt and water from entering.

Description

- When connected with a IP67 plug, it satisfies the requirements of the protection class IP67
- Connection with commercially available RJ45 plugs possible (no IP protection)
- Plug surface in accordance with IEC 61076-3-106 (Option 6)
- Environment class M_3 I_3 C_3 E_3 in accordance with EN 50173-2
- IP67- Casing cover permanently attached
- Connection unit with an 8-position RJ45 jack
- Easy, time-saving installation
- EBM design suitable for MS 1/8 Module Cat 6
- Counter-plate made of sturdy zinc die casting
- Mounting strip included

Dimensions

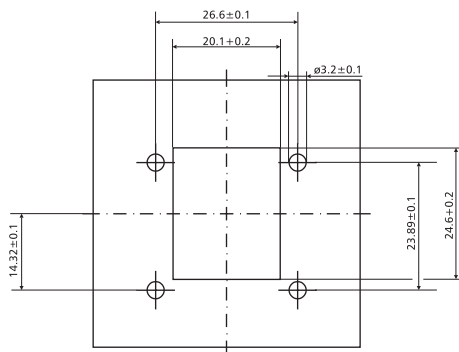

Article No.	Description	Colour (similar)	PU
185 726	Mounting flange IP67 with mounting kit, unloaded	light grey RAL 7035	1 unit
185 700	module MS1/8 Cat 6, screened TIA-A	metallic	10 pieces
1414 227	module MS1/8 Cat 6, screened TIA-B	metallic	10 pieces

Montagevorbereitung Preparation

1a

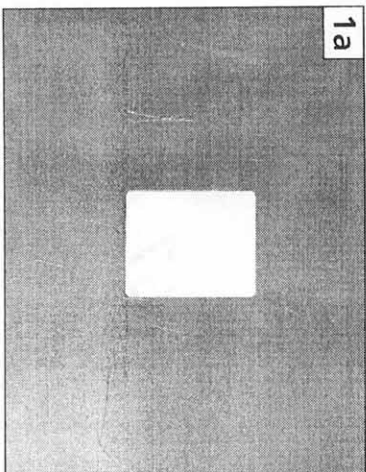

Einbauöffnung gemäß Einbausschnitt ausschneiden.
(siehe Rückseite)
Cut the opening according to the cutout dimensions
(see reverse page).

1b

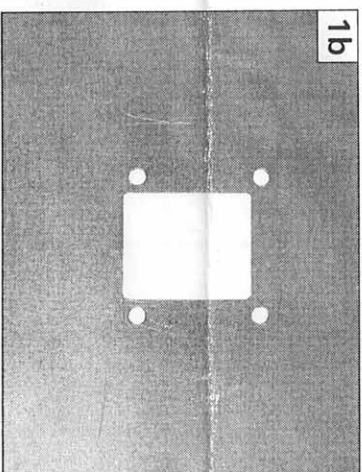

Anschließend die vier Befestigungslöcher gemäß der Maßzeichnung bohren. Je nach Stärke kann ein Gewinde in die Bohrlöcher geschnitten werden. (Bohrlöcher dann entsprechend kleiner bohren!) Ansonsten das Montageset verwenden.
Then drill the four fixing holes as per the dimensional drawing. Depending on the material thickness cut a thread in the drilled holes (in this case drill proportionately smaller holes). Otherwise use the mounting kit.

Montage Mounting

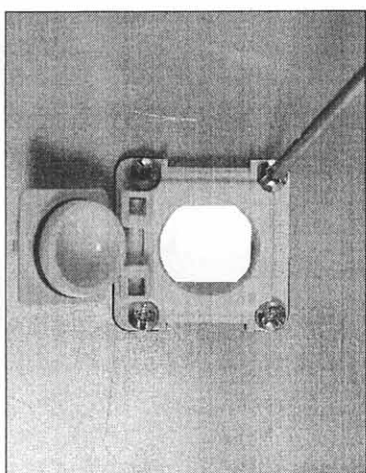

Ohne Montageset

Einbauflansch von vorne anschrauben.
Without mounting kit
Screw the mounting flange to the front surface.

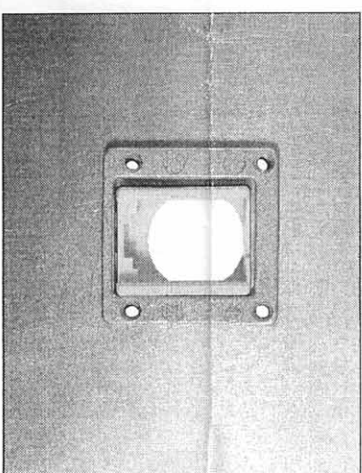

Mit Montageset

Gegenplatte des Montagesets von hinten ansetzen ...
With mounting kit
Place the fixing plate on the rear surface ...

Montage Mounting

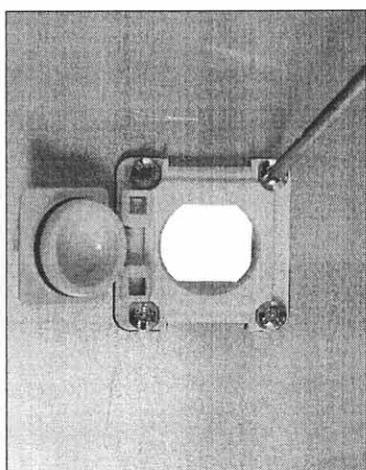

... und von vorne verschrauben.
... and screw through from the front.

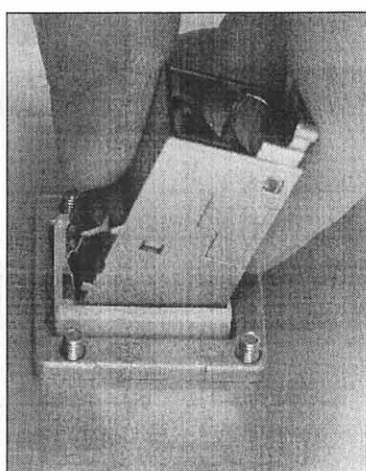

Einbau MS1/8 Modul Cat.6

Einsetzen von MS1/8 Modul in Einbauflansch. Oben einhängen und nach unten einrasten.

Installing the MS1/8 Module Cat.6

Hook the top of the MS1/8 Module in to the top of the installation flange and click it downwards in to place.

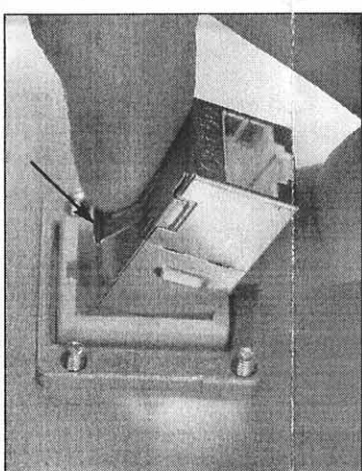

Einbau RJ45 STP-Kupplung Cat.5e

Einsetzen von RJ45 STP-Kupplung Cat.5e in Einbauflansch. Oben einhängen und nach unten einrasten, dabei Klemmblech leicht eindrücken.

Installing a RJ45 STP Coupler Cat.5e

Hook the top of the RJ45 Coupler in to the top of the installation flange and click it downwards in to place while slightly pressing the metal spring.



Hinweis: / Notes:

Der Einbauflansch kann bei einer Materialstärke von mindestens 1 mm und maximal 5 mm verwendet werden.

The mounting flange can be used with materials having a thickness of at least 1 mm and not more than max. 5 mm.

Montageanleitung Mounting Instructions

Entsprechend Norm-Entwurf IEC 61076-3-106 Var. 6
Complies with draft of standard IEC 61076-3-106 Var. 6

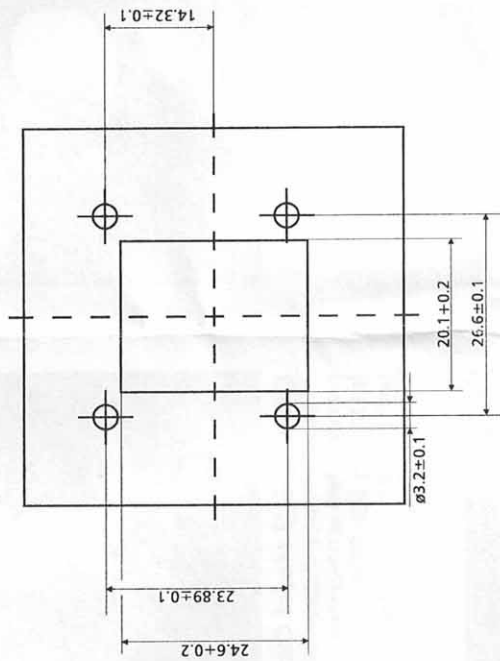

Einbaufansch IP67 Mounting Flange IP67

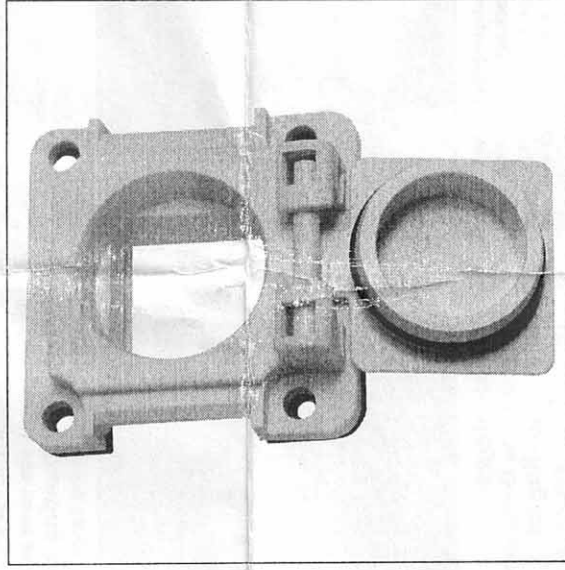

Schweiz/Switzerland
Dätwyler Kabel+Systeme AG

Gotthardstrasse 31
CH-6460 Altdorf
Telefon: +41 41/8751268
Telefax: +41 41/8751986
e-mail: cable.swiss@daetwyler.ch
www.daetwyler.net

Deutschland/Germany
Dätwyler Kabel+Systeme GmbH

Gottfried-von-Cramm-Strasse 1
D-85375 Neufahrn
Telefon: +49 8165/9501-110
Telefax: +49 8165/9501-130
e-mail: info@daetwyler.net
www.daetwyler.net

082006/50/01/D/899 072-02