



Product information

AP Connector Box Industrial IP67 for 1 MU 1/8 modules

Application

The use of Ethernet protocols is increasingly transferred to harsh, industrial environments exposed to pollution. With this in mind, Dätwyler is offering the MU Industrial IP67 System which is based on the proven and tested MU Modules System. The future-proof system for the connection of 8 wires consists of Cat 6 RJ45 Industry connector boxes, as well as Cat 6 RJ45 Industrial connectors, which fulfill the requirements for a Class E (250 MHz) transmission distance in accordance with ISO/IEC 11801:2002 and EN 50173-1:2002.

The components are utilized in the area of structured cabling within the harsh industrial sector (protection class IP67) according to EN 50173-2 (design). (Environment classes $M_3 I_3 C_3 E_3$). In order to ensure a secure data transmission, the modular inserts aligned with each other offer a large surface 360° contact of the cable screen, which has excellent EMV properties.

The cover permanently attached to the casing of the connector box serves to close the opening of the jack when unmated, and prevents dust, dirt and water from entering.

Description

- When connected to an IP67 plug, it fulfills the protection category IP67.
- Connection with commercially available RJ45 plugs possible (no IP protection)
- Plug surface in accordance with IEC 61076-3-106 (Option 6)
- Environment class $M_3 I_3 C_3 E_3$ in accordance with EN 50173-2
- IP67 closing cover permanently attached
- Add-on surface mounting possible
- Modules easy to open, reusable
- Add-on unit with an 8-contact RJ45 jack
- Easy, time-saving installation
- Completely screened modules

Dimensions

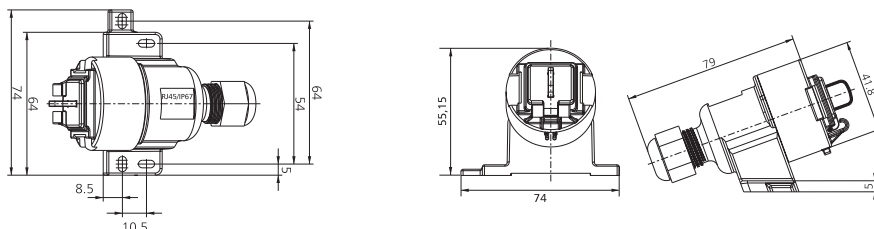

Article No.	Description	Colour (similar)	PU
185 719	AP casing IP67 for MU 1/8 Modules, unloaded	light grey RAL 7035	1 unit
185 750	module MU 1/8 Cat 6, unscreened, TIA-A	white	10 pieces
185 751	module MU 1/8 Cat 6, unscreened, TIA-B	white	10 pieces
185 720	Plug casing IP67, incl. 1 RJ45 plug	light grey RAL 7035	1 unit