

## AGER AGENA COMPACT SERIES

AG-AC12U6045S1-CBAA-A-D1

**AGER** Agena Compact series wall mounted cabinets; They are cabinets that meet medium-sized network installation needs. According to the equipment to be used, the mounting of the device can be adjusted in the depth of the cabinet. Thanks to its wall-mountable apparatus and panel structure, its functionality increases and it creates great solutions in small spaces. In addition to its technical and robust structure, it has an aesthetic appearance with its decorative metal frame.



### Material

- 0.8 mm DKP
- 1.2 mm DKP

### IP Classification

- As a standard IP20

### Color Options

- RAL9005 Black
- RAL7035 White

### Loading Capacity

- Recommended up to 80 kg
- Loading capacity

### Doors

- Door options are available.
- Single point locking system.
- Doors can be opened to 236 degree.
- Doors can be opened to left or right direction.

### Mounting Rails

- 1.5mm DX51D galvanic
- 19" Mounting rails; adjustable in depth of the cabinet

### Side Panels

- Locking system is available, side panels are removable.

### Bottom Sheet

- A microjointed cable entry and easily breakable panel are available.

### Ground contact

- Leveling feet options are available.

### Top Sheet

- A microjointed cable entry and easily breakable panel are available.

### Color Options

RAL7035 Grey

RAL9005 Black

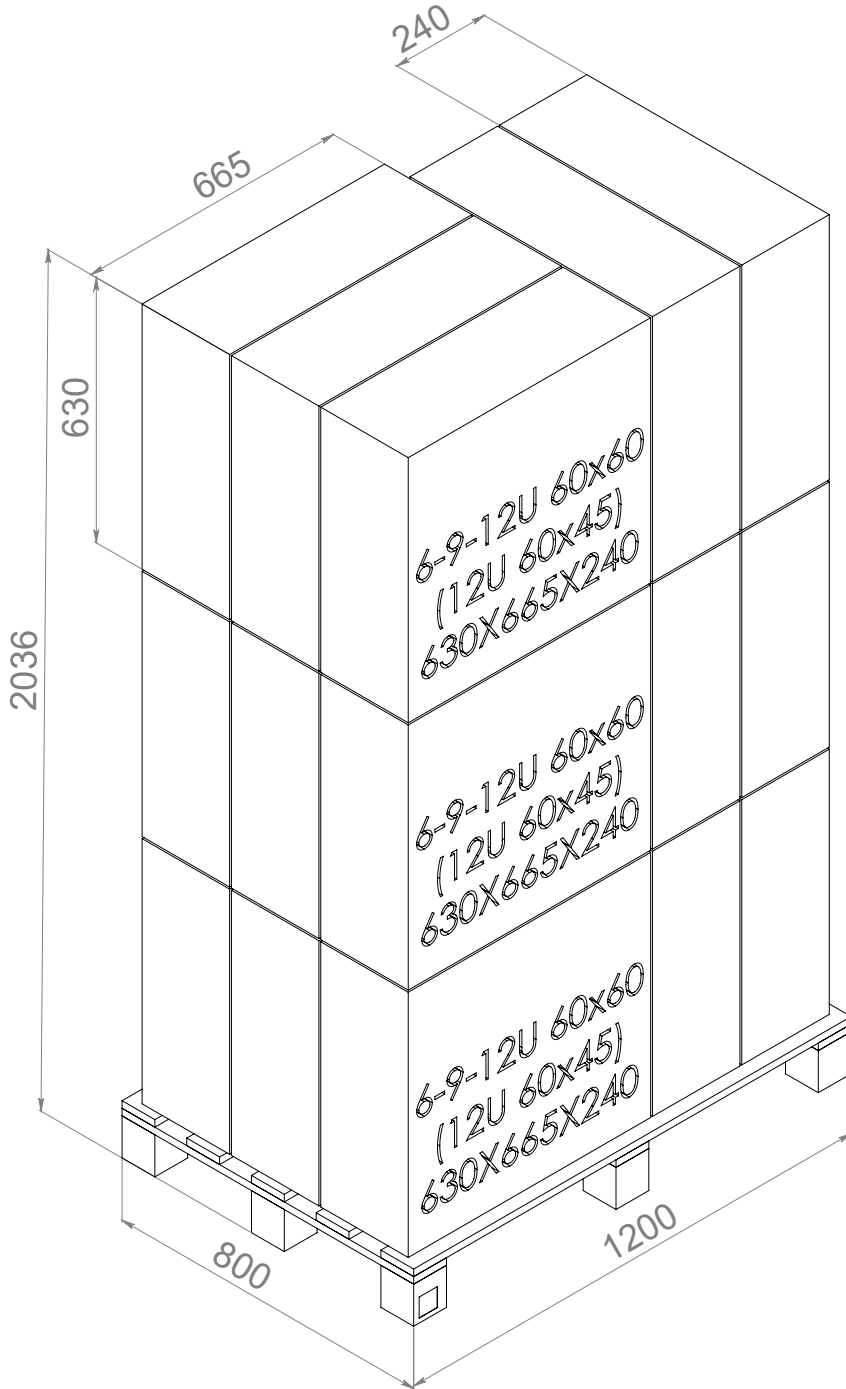

06U 600X600  
09U 600X600  
12U 600X450  
12U 600X600

1 PALLET 15 PCS.

(All dimensions are in mm.)

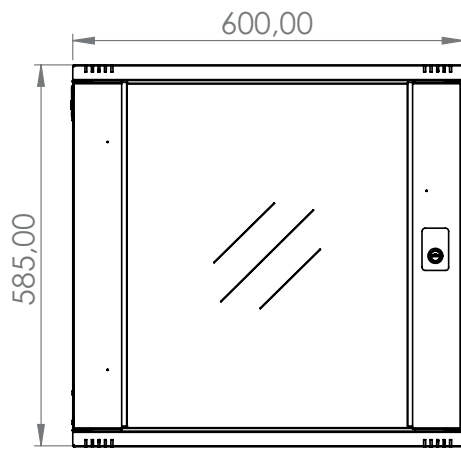

FRONT VIEW

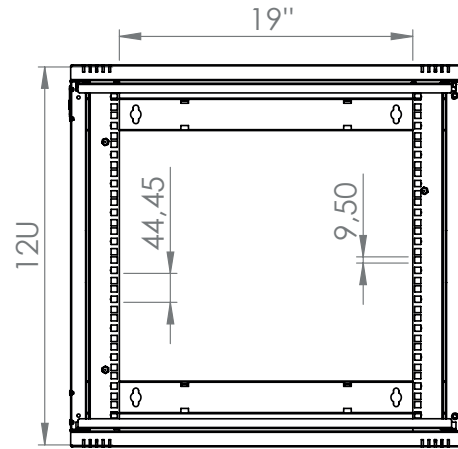

FRONT VIEW WITHOUT COVER

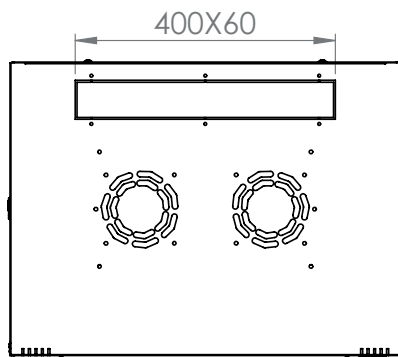

TOP VIEW

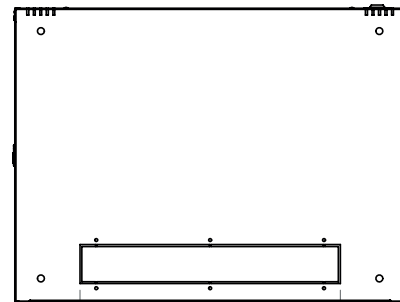

BOTTOM VIEW

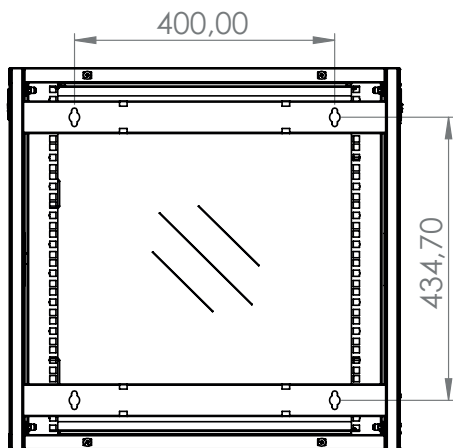

BACK VIEW WITHOUT COVER

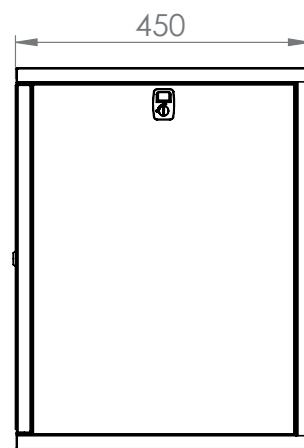

SIDE VIEW

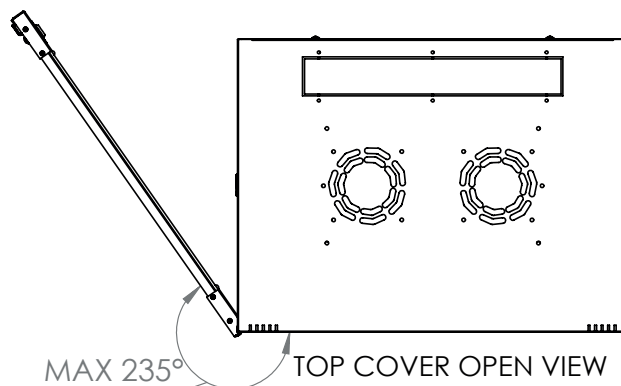

TOP COVER OPEN VIEW